

EXTENT OF CONCRETE FOOTPATH (BLEND IN ON SITE).

CONSTRUCT 1.8m WIDE CONCRETE FOOTPATH AND UPGRADE CROSSOVER APRONS.

LEGEND	
	EXISTING MANHOLE
	EXISTING SIDE ENTRY PIT
	EXISTING GRATE
	EXISTING DRAINAGE LINE
	PROPOSED DRAINAGE LINE
	PROPOSED SIDE ENTRY PIT
	PROPOSED MANHOLE
	PROPOSED COMBINATION PIT
	HYDRANT
	PROPOSED SEMI MOUNTABLE KERB
	PROPOSED BARRIER KERB
	EXTENT OF WORKS
	PRAM RAMP
	CONCRETE FOOTPATH & CROSSOVER
	ASPHALT BLACK 25mm
	REMOVE EXISTING PAVEMENT

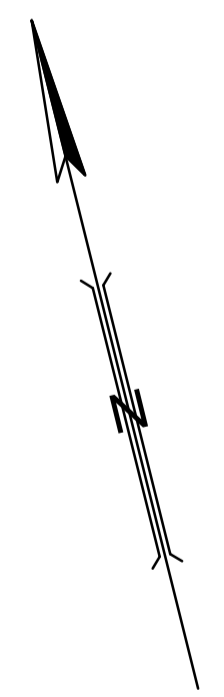

SCALE
1 : 250 @ A1

METRES

SURVEYED
TOPOGRAPHICAL
DESIGNED
G HEGDE MAY 2019
DRAWN
D RYAN MAY 2019
CHECKED

ADOPTED BY COUNCIL
C19/
APPROVED

BEACH STREET
BLACKWALL REACH PDE TO PT WALTER RD
BICTON
ROAD RESURFACING 2018/2019

CAD FILE
K:\CAD2019\Paths 2019-2020\Bicton\Beach Street
DRAWING STATUS
DRAFT
SHEET
1 of 3
PLAN No.
0000A1-19E
AMENDMENT
0

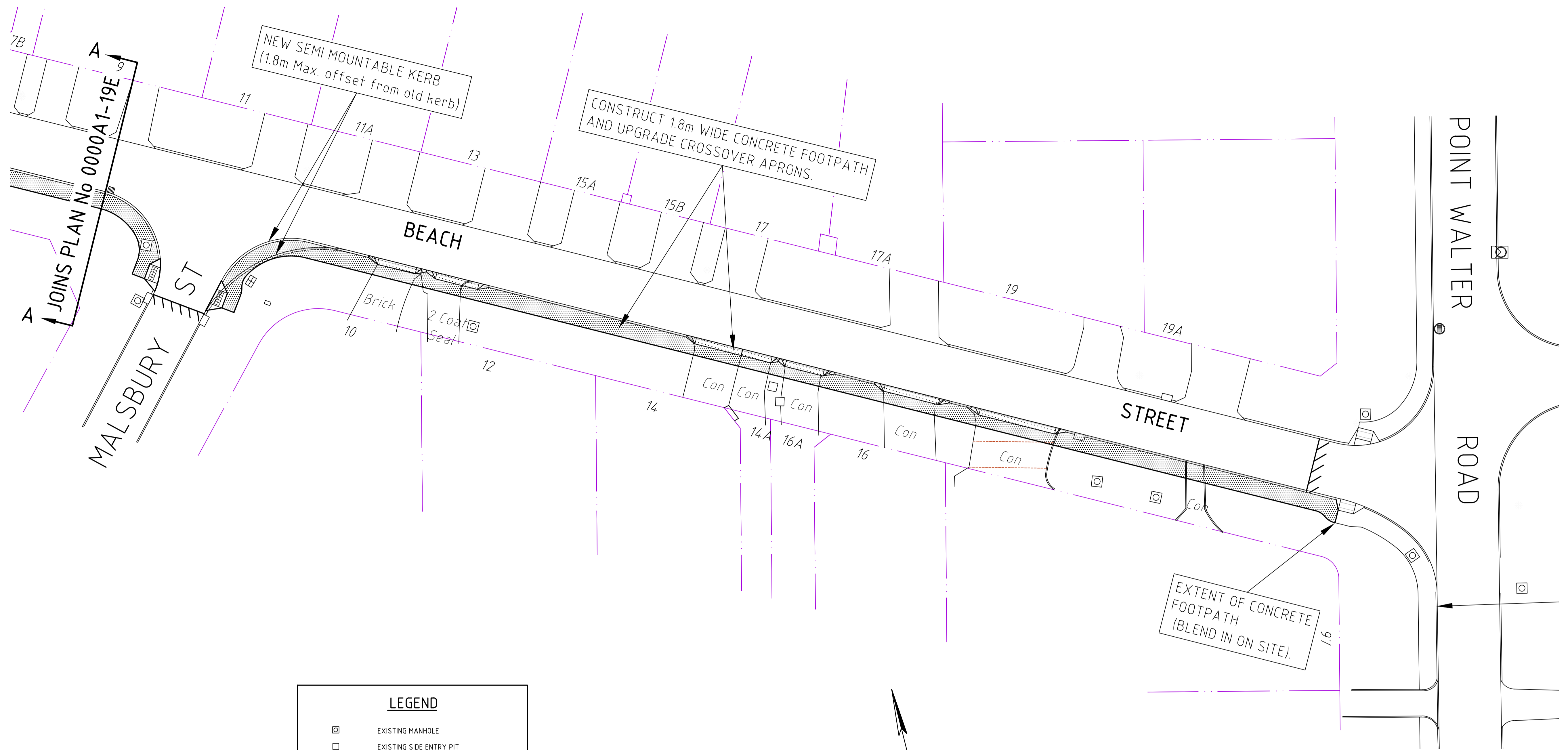

LEGEND	
	EXISTING MANHOLE
	EXISTING SIDE ENTRY PIT
	EXISTING GRATE
	EXISTING DRAINAGE LINE
	PROPOSED DRAINAGE LINE
	PROPOSED SIDE ENTRY PIT
	PROPOSED MANHOLE
	PROPOSED COMBINATION PIT
	HYDRANT
	PROPOSED SEMI MOUNTABLE KERB
	PROPOSED BARRIER KERB
	EXTENT OF WORKS
	PRAM RAMP
	CONCRETE FOOTPATH & CROSSOVER
	ASPHALT BLACK 25mm
	REMOVE EXISTING PAVEMENT

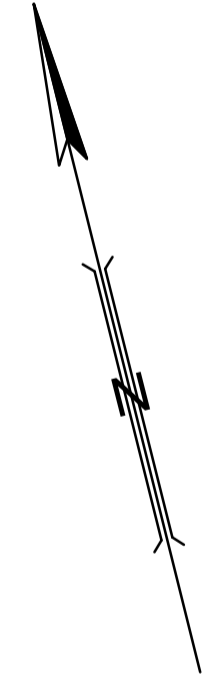

SCALE
 1 : 250 @ A1

SURVEYED
 TOPOGRAPHICAL
DESIGNED
 G HEGDE MAY 2019
DRAWN
 D RYAN MAY 2019
CHECKED

ADOPTED BY COUNCIL
 C19/
APPROVED

BEACH STREET
 BLACKWALL REACH PDE TO PT WALTER RD
 BICTON
 ROAD RESURFACING 2018/2019

CAD FILE K:\CAD2019\Paths 2019-2020\Bicton\Beach Street	SHEET 2 of 3
DRAWING STATUS DRAFT	AMENDMENT 0
PLAN No. 0000A1-19E	

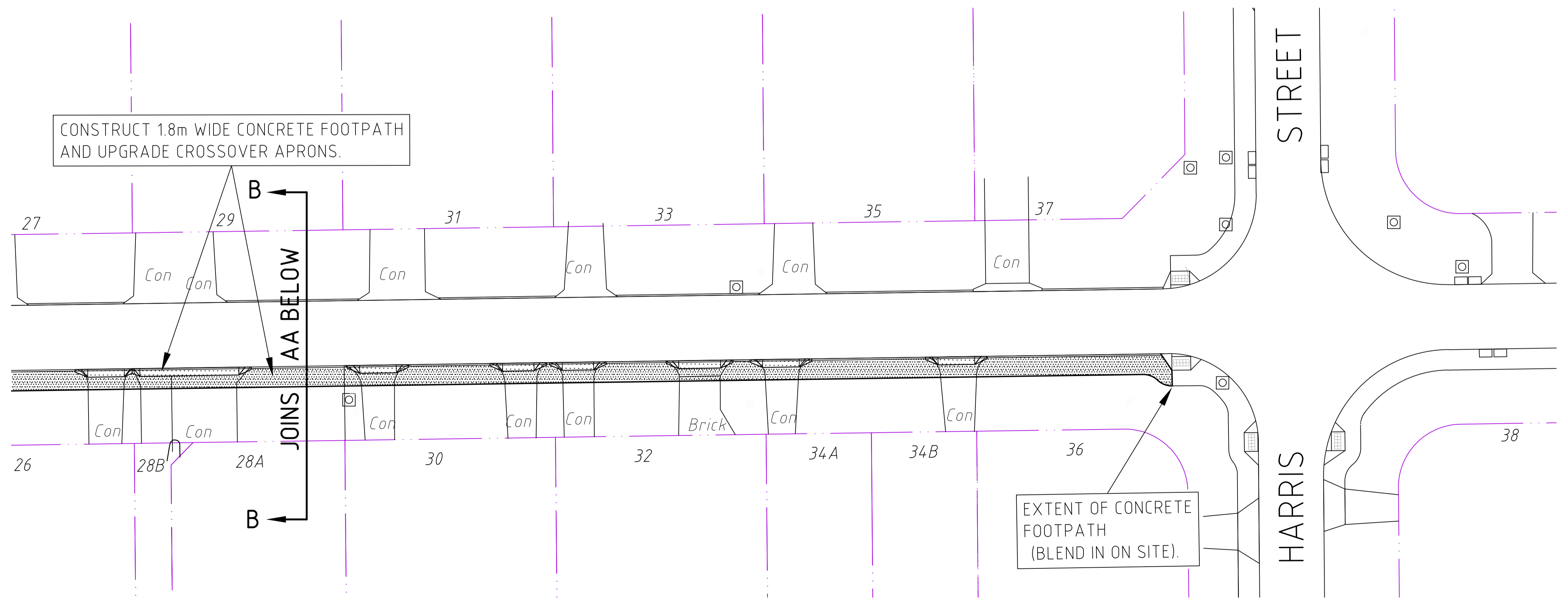
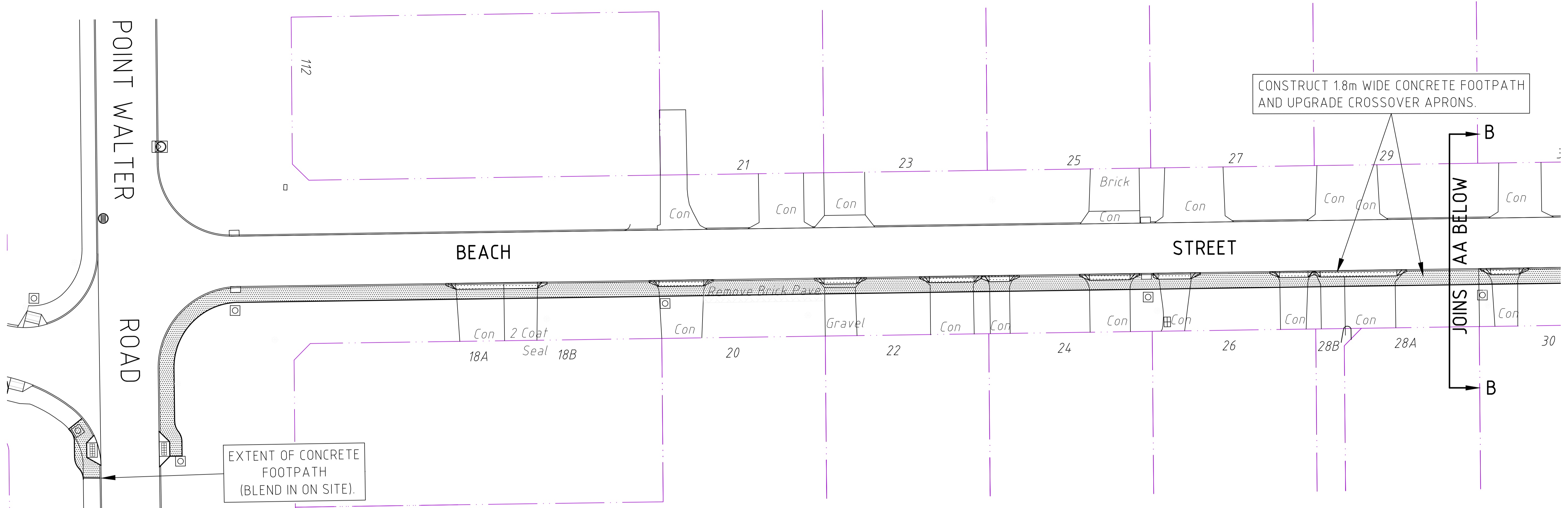

LEGEND	
	EXISTING MANHOLE
	EXISTING SIDE ENTRY PIT
	EXISTING GRATE
	EXISTING DRAINAGE LINE
	PROPOSED DRAINAGE LINE
	PROPOSED SIDE ENTRY PIT
	PROPOSED MANHOLE
	PROPOSED COMBINATION PIT
	HYDRANT
	PROPOSED SEMI-MOUNTABLE KERB
	PROPOSED BARRIER KERB
	EXTENT OF WORKS
	PRAM RAMP
	CONCRETE FOOTPATH & CROSSOVER
	ASPHALT BLACK 25mm
	REMOVE EXISTING PAVEMENT



SCALE
1 : 250 @ A1

METRES

SURVEYED
TOPOGRAPHICAL
DESIGNED
G HEGDE MAY 2019
DRAWN
D RYAN MAY 2019
CHECKED

ADOPTED BY COUNCIL
C19/
APPROVED

BEACH STREET
BLACKWALL REACH PDE TO PT WALTER RD
BICTON
ROAD RESURFACING 2018/2019

CAD FILE K:\CAD2019\Paths 2019-2020\Bicton\Beach Street	SHEET 3 of 3
DRAWING STATUS DRAFT	AMENDMENT 0
PLAN No. 0000A1-19E	