

APPLECROSS SENIOR HIGH SCHOOL

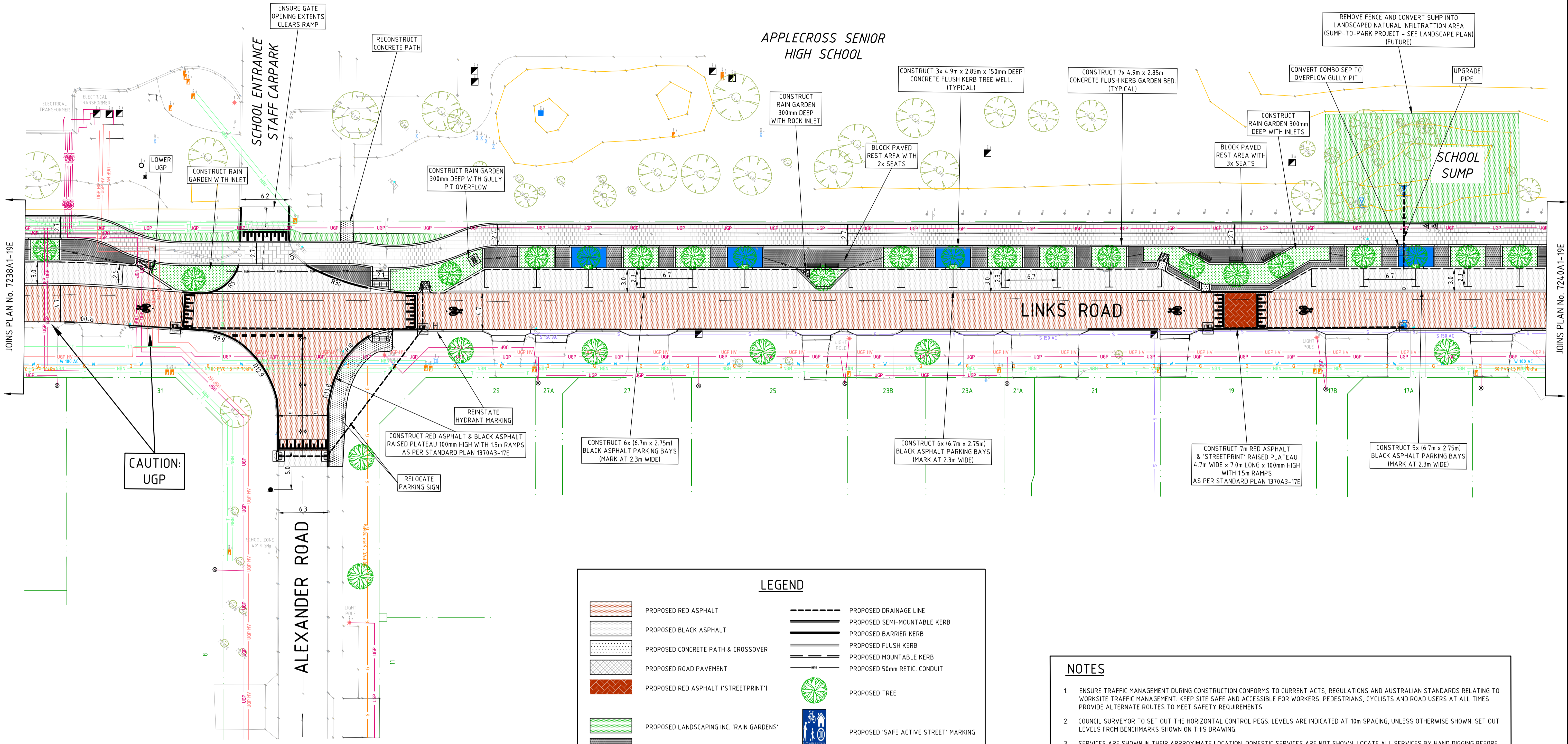

JOINS PLAN No. 7238A1-19E

JOINS PLAN No. 7240A1-19E

METHOD FOR ROAD PAVEMENT

- REMOVE EXISTING SEAL & KERB.
- WHERE EXISTING LEVEL IS BELOW DESIGN LEVEL, ADD CORRECTOR TO ACHIEVE DESIGN LEVEL AS NECESSARY.
- WHERE EXISTING LEVEL IS ABOVE DESIGN LEVEL, MILL OUT EXISTING PAVEMENT TO ACHIEVE DESIGN LEVEL AND ENSURE 250mm BASE COURSE REMAINS OTHERWISE FULL DEPTH RECONSTRUCTION.
- COMPACT TO 98% MDD AND GRADE TO DESIGN LEVELS.
- EMULSION SEAL WITH 5mm STONES.
- CONSTRUCT NEW KERBS/CROSSOVERS WHERE SHOWN.
- FINAL WEARING COURSE TO BE 30mm THICK 7mm DGT RED OR BLACK ASPHALT, 50 BLOW FOR INTERSECTIONS AND PLATEAUS AND 30mm THICK 5mm SMA FOR ROAD SECTIONS.

LEGEND

	PROPOSED RED ASPHALT		PROPOSED DRAINAGE LINE
	PROPOSED BLACK ASPHALT		PROPOSED SEMI-MOUNTABLE KERB
	PROPOSED CONCRETE PATH & CROSSOVER		PROPOSED BARRIER KERB
	PROPOSED ROAD PAVEMENT		PROPOSED FLUSH KERB
	PROPOSED RED ASPHALT ('STREETPRINT')		PROPOSED MOUNTABLE KERB
	PROPOSED LANDSCAPING INC. 'RAIN GARDENS'		PROPOSED 50mm RETIC. CONDUIT
	PROPOSED BLOCK PAVING BUFFER ZONE		PROPOSED TREE
	PROPOSED ROCK REVETMENT		PROPOSED 'SAFE ACTIVE STREET' MARKING
	PROPOSED SIGN		PROPOSED COMBINATION SIDE ENTRY PIT
	PROPOSED SEATING		PROPOSED SIDE ENTRY PIT
			PROPOSED GULLY PIT
			PROPOSED MANHOLE

- NOTES**
1. ENSURE TRAFFIC MANAGEMENT DURING CONSTRUCTION CONFORMS TO CURRENT ACTS, REGULATIONS AND AUSTRALIAN STANDARDS RELATING TO WORKSITE TRAFFIC MANAGEMENT. KEEP SITE SAFE AND ACCESSIBLE FOR WORKERS, PEDESTRIANS, CYCLISTS AND ROAD USERS AT ALL TIMES. PROVIDE ALTERNATE ROUTES TO MEET SAFETY REQUIREMENTS.
 2. COUNCIL SURVEYOR TO SET OUT THE HORIZONTAL CONTROL PEGS. LEVELS ARE INDICATED AT 10m SPACING, UNLESS OTHERWISE SHOWN. SET OUT LEVELS FROM BENCHMARKS SHOWN ON THIS DRAWING.
 3. SERVICES ARE SHOWN IN THEIR APPROXIMATE LOCATION. DOMESTIC SERVICES ARE NOT SHOWN. LOCATE ALL SERVICES BY HAND DIGGING BEFORE EXCAVATION. PROVIDE ADEQUATE SUPPORT & PROTECTION FOR EXPOSED SERVICES.
 4. REFER TO CITY OF MELVILLE SPECIFICATIONS AND DRAWINGS FOR KERBING, PEDESTRIAN RAMPS, TREE WELL DETAILS, ASPHALT AND DRAINAGE WORKS.
 5. ADVISE MRWA TO INSTALL REGULATORY ROAD SIGNS AND LINE MARKING.
 6. RESTORE VERGES, RETICULATION, CROSSOVERS AND 'SAFE ROUTES TO SCHOOLS' MARKINGS TO THEIR ORIGINAL CONDITION.
 7. RED ASPHALT SHALL BE AT LEAST 70% CRUSHED LATERITE GRAVEL.
 8. ALL NEW FOOTPATHS AND KERBS TO BE INSTALLED ABOVE FINISHED LEVEL OF GUTTER.



SCALE
1 : 500 @ A3

SURVEYED S PAULOSE AUGUST 2018	ADOPTED BY COUNCIL
DESIGNED J GRADISEN MARCH 2019	
DRAWN J GRADISEN MARCH 2019	APPROVED
CHECKED	

LINKS RD, COLLIER ST,
MILLINGTON ST, HOPE RD
ADDRESS
SAFE ACTIVE STREET

CAD FILE	
DRAWING STATUS DRAFT	SHEET
PLAN No. 7239A1-19E	AMENDMENT 0