



# Waste Management Plan

## Introduction

This Waste Management Plan ('WMP') has been prepared for the proposed Child Care Centre at Lot 1 (No.2c) Matheson Road, Applecross ('site').

The WMP has been prepared in accordance with Local Planning Policy 1.3 ('LPP1.3') and sets out the anticipated waste generation levels, bin storage requirements and waste collection approach of the Child Care Centre, once operational.

The WMP does not consider waste management during construction, which may need to be addressed at the Building Permit stage. Subject to any relevant conditions of Development Approval, waste collection and disposal is to be undertaken in accordance with this WMP.

## Proposed Development

Item	Proposed
Land Use	Child Care Centre
Number of Tenants / Businesses	1
Gross Building Area	563m <sup>2</sup>
Area of Activity Rooms	257m <sup>2</sup>
External Play Areas	474m <sup>2</sup>
Number of Children	67
Number of Staff	15
Operating Days	Monday to Friday

## Waste Generation Rates

LPP1.3 does not specify a waste generation rate for Child Care Centres. The Commercial and Industrial Waste Management Guidelines published by the Western Australian Local Government Association include estimated waste generation rates for various land uses. The WALGA rates were derived from the Better Practice Guidelines for Waste Management and Recycling in Commercial and Industrial Facilities published by the New South Wales Environmental Protection Authority. Neither document includes a specific waste generation rate for Child Care Centres.

Waste generation rates published by the City of Melbourne and City of Casey in Victoria suggest a Child Care Centre generates 350 litres of general and recyclable waste per 100m<sup>2</sup> of floor area per week. A review of other Waste Management Plans indicates this rate is based on 7 days a week, equating to 50 litres per day per 100m<sup>2</sup>, with floor area based on the area of the Activity Rooms in the Child Care Centre.



Based on the above assumptions, it is estimated the proposed Child Care Centre will generate the following amount of waste.

Item	General Waste	Recyclable Waste
Waste Generation Rate	50 Litres / 100m <sup>2</sup> / Day	50 Litres / 100m <sup>2</sup> / Day
Floor Area	257m <sup>2</sup>	257m <sup>2</sup>
Trading Days	5	5
Daily Waste	128.5 Litres	128.5 Litres
Weekly Waste	642.5 Litres	642.5 Litres

### Other Waste Requirements

- Liquid or Hazardous Waste: Not Applicable
- Medical Waste: Not Applicable
- Food Processing: Not Applicable

### Bin Selection

#### Type and Number of Bins

- General Waste: 3 x 240 Litre Bins
- Recyclable Waste: 3 x 240 Litre Bins
- Total Bins: 6 x 240 Litre Bins

#### Collector

City of Melville

#### Frequency of Collection

Weekly

### Bin Compound

The Bin Compound is shown on the drawings for the Development Application and is of sufficient size (8.2m<sup>2</sup>) to accommodate 6 x 240 Litre bins, as illustrated below. The Bin Compound will be designed in accordance with the requirements of Clause 5.4 (a) to (f) of LPP1.3 and is conveniently located for access by the tenant.

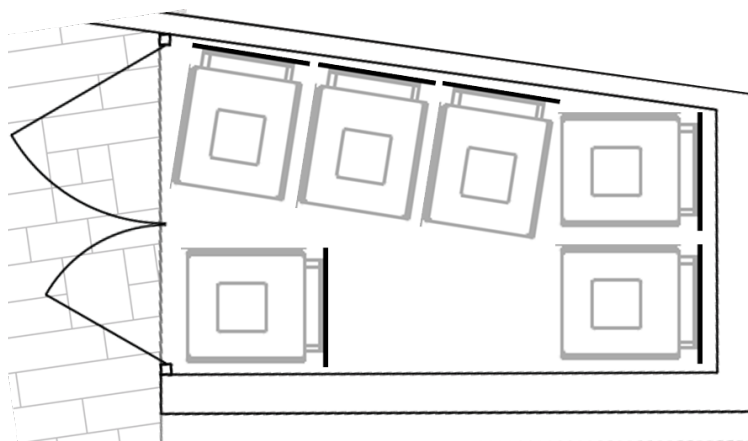

*Bin Compound*



### Collection Point

Kerb side. Staff will be responsible for wheeling bins to the verge in the evening before the day of collection and returning bins to the store after collection. The proposed collection point is illustrated below.

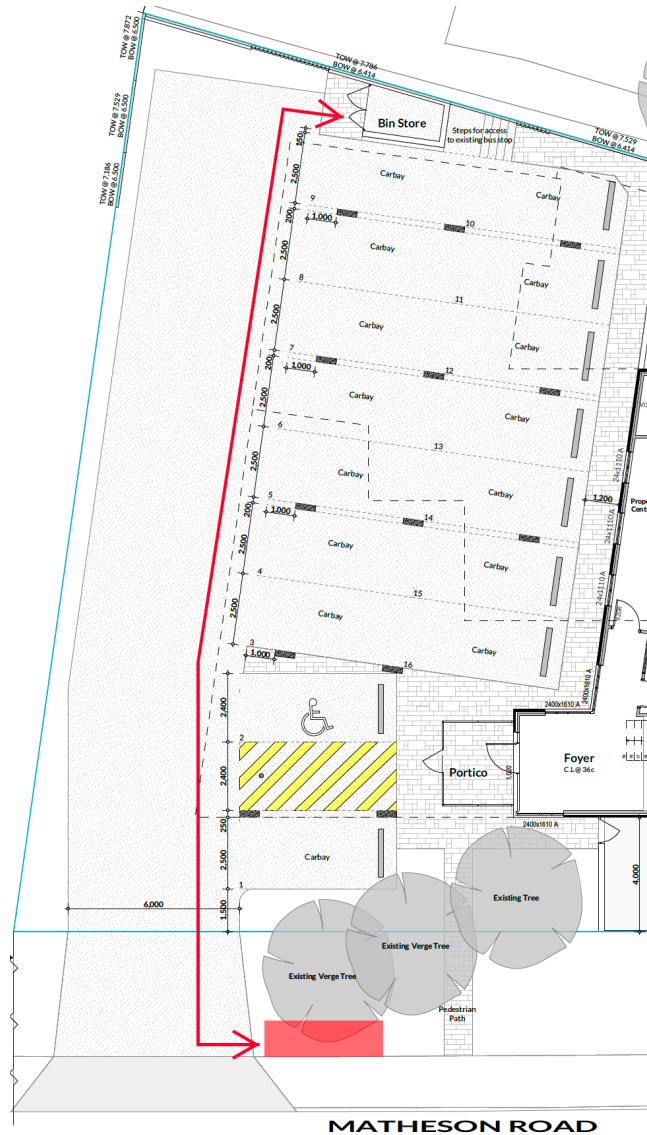

*Proposed Bin Collection Point*