



City of
Melville

AGENDA BRIEFING FORUM

T21/3946

RFT202111 – Construction of South East Premier Playspace
at Bob Gordon Reserve

Presenters: Mario Murphy, Manager City Buildings
Janine Ahola, Landscape Architect Coordinator

September 2021



City of
Melville

T21/3946

RFT202111 – Construction of South East Premier Playspace

Presenters: Mario Murphy, Manager City Buildings

Janine Ahola, Landscape Architect Coordinator

Agenda

- Background
- Timeline
- Design
- Tender Process
- Funding
- Recommendation





City of
Melville

Background

Vision

“To create an inclusive, multi-generational, accessible and distinctive play space to address the current inequality in the South East quadrant of our City.”

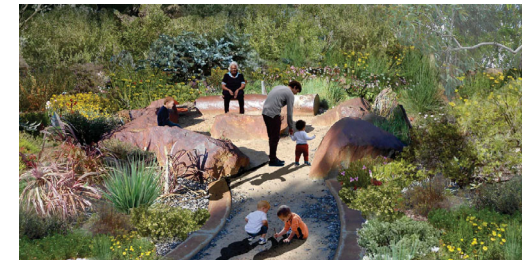
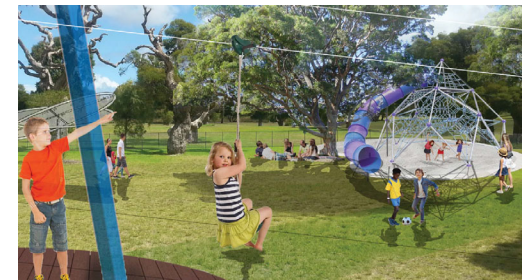



July 2016

T16/3714 Exploration of suitable location requested.

March 2017

Community Reference Group recommend Bob Gordon Reserve.

July 2017

EMIS concept plan presentation prior to broader engagement.

November 2017

Concept plan revised and released for Information.

August 2019

EMIS update - \$4 million estimate

June 2021

Project approved in Capital Works Programme - \$3.63m total budget



SENIOR STATION 1



TIDE CLIMB



South East Premier Playspace Site Plan





Key elements include:

- An iconic central feature;
- Play options for differing abilities;
- Retention and improvement of existing vegetation;
- Creation of a shared path network;
- Recreational areas;
- Accessible toilet facilities, shade and seating;
- Remediation of existing facilities.

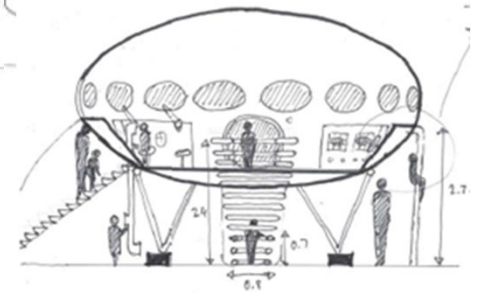



City of
Melville

Tender Process

- ▶ Tender issued in June 2021
- ▶ Tenders received (5 no.) July 2021
- ▶ Evaluation July 2021
- ▶ CTAU August 2021





Costs:

- Tender returns have pushed project costs 12% above budget.

Funding:

- Approved budget is \$3,630,380
- Additional funds of \$430,574 to be taken from the Capital Works New/Upgrade reserve fund
- Total funding amounting to \$4,060,954 required to complete project



Officer Recommendation

That the Council



1. Accept the recommendation as contained in the Confidential Attachment – RFT202111 Contract and Tender Advisory Unit Minutes,
2. By absolute majority decision increases the project budget for South East Premier Playspace (PLG04653) by \$430,574 and that this increase be funded by increasing the transfers from the Public Open Space and Urban Forest Reserve.