

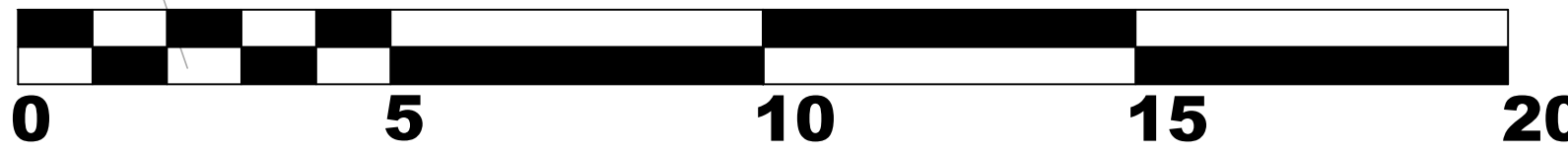

This drawing is conceptual. Check scale carefully against boundary measurements. Scalebars can be inaccurate. Measurements should be checked on-site prior to quotation and construction. Plans should be printed at actual size on the same sized paper shown in the title block. Fitting to page and adding margins can alter the scale when printed.

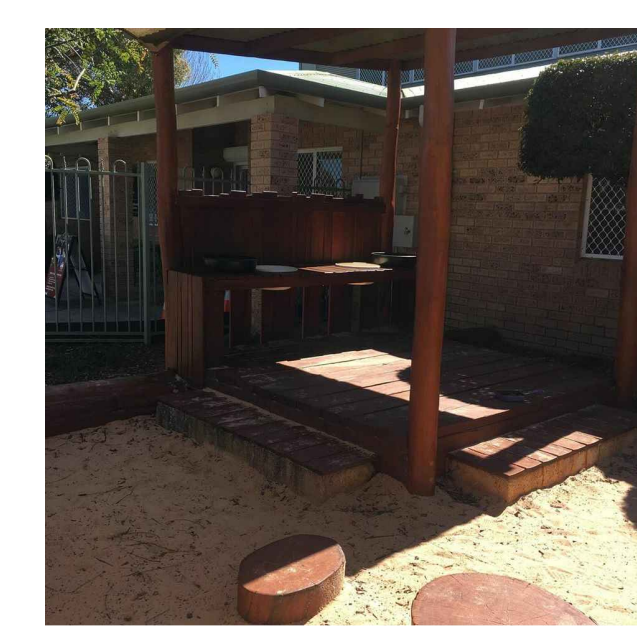

LOG AND STEPPERS



SAND KITCHEN



TRELLIS



FORT WITH SLIDE



CREEK

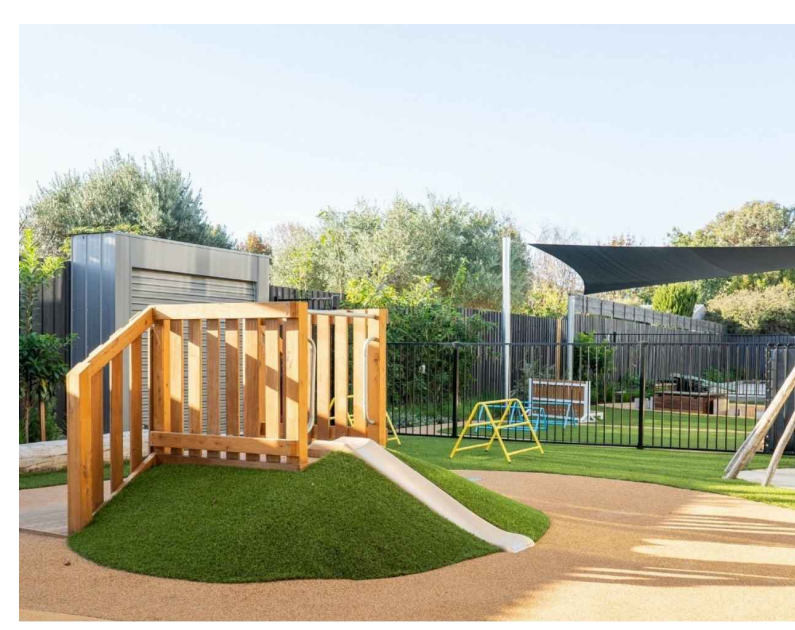

HILL FORT

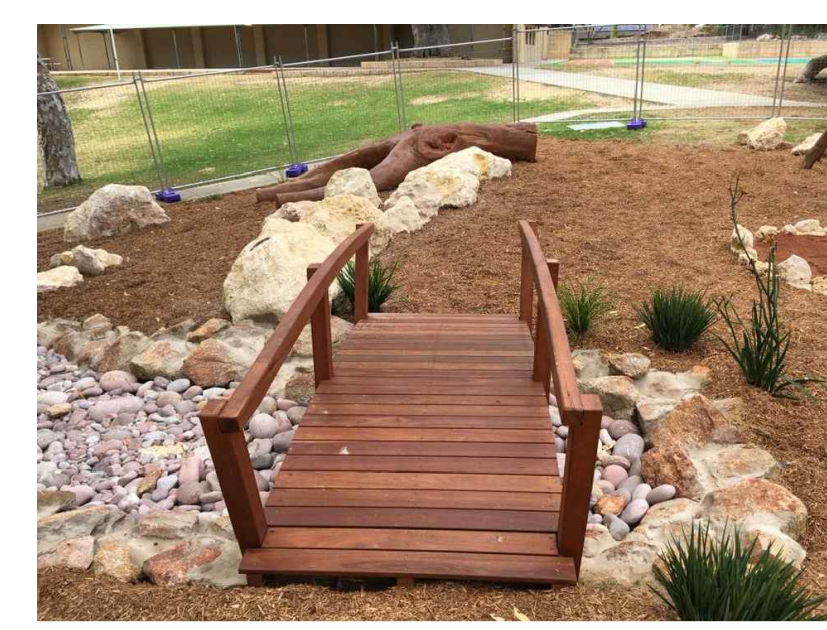

BRIDGE



P.O. Box 774  
e-mail: admin@childscapes.com.au  
web: childscapes.com.au

PROJECT BATEMAN (MEYERSHIRECORE)		DRAWING OVERALL CONCEPT PLAN				ISSUE ISSUED FOR FEEDBACK			REVISIONS			
CLIENT -		DRAWING NO L-01	SCALE 1:100	SHEET A1	REVISION 0	DRAWN NK	DATE 13/12/24		No	DATE	DRAWN	DETAILS
									0	13/12/24	NK	CONCEPT- ISSUED FOR FEEDBACK





TREES:



PYRUS CALLERYANA



AGONIS FLEXUOSA

SHRUBS:



ROSEMARY OFFICINALIS



ANIGOZANTHOS MANGLESII



EREMOPHILA GLABRA



ADENANTHOS SERICEUS



HIBISCUS TILIACEUS



P.O. Box 774  
e-mail: admin@childscapes.com.au  
web: childscapes.com.au

PROJECT  
BATEMAN  
(MEYERSHIRECORE)

CLIENT  
-

DRAWING  
PLANTING PLAN

DRAWING NO  
L-02

SCALE  
1:100

SHEET  
A1

REVISION  
0

ISSUE  
ISSUED FOR FEEDBACK

DRAWN  
NK

DATE  
13/12/24

REVISIONS







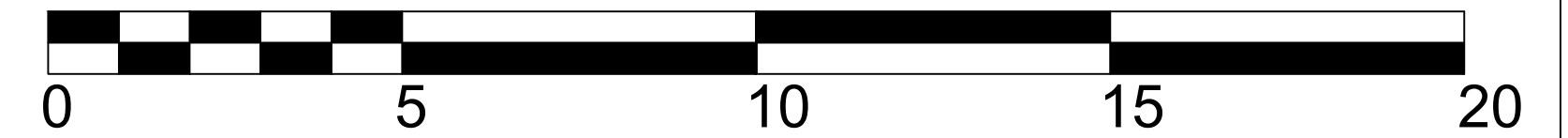



No	DATE	DRAWN	DETAILS
0	13/12/24	NK	PLANTING- ISSUED FOR FEEDBACK



This drawing is conceptual. Check scale carefully against boundary measurements. Scalebars can be inaccurate. Measurements should be checked on-site prior to quotation and construction. Plans should be printed at actual size on the same sized paper shown in the title block. Fitting to page and adding margins can alter the scale when printed.



## IRRIGATION SCHEDULE

SYMBOL	MANUFACTURER/MODEL/DESCRIPTION
	HUNTER PROS SHORT RADIUS NOZZLES SHRUB SPRAY, 300MM POP-UP. CO-MOLDED WIPER SEAL
	HUNTER PROS ADJUSTABLE ARC SHRUB SPRAY, 300MM POP-UP. CO-MOLDED WIPER SEAL WITH UV RESISTANT MATERIAL.
	
SYMBOL	MANUFACTURER/MODEL/DESCRIPTION
	MASTER VALVE RAIN BIRD DVF STANDARD CONFIGURATION. ELECTRIC REMOTE CONTROL VALVE. PLASTIC RESIDENTIAL IN 25MM. WITH FLOW CONTROL.
	RAIN BIRD DVF (GARDENS) 25MM
	HUNTER PRO HC - 24 STATION CONTROLLER PROPOSED LOCATION
	WATER SOURCE ASSUMED LOCATION
	RAIN BIRD QUICK-COUPLING VALVE
	RAIN BIRD TREE DRIP IRRIGATION
	IRRIGATION LATERAL LINE: UPVC CLASS 9 25MM
	IRRIGATION MAINLINE: UPVC CLASS 9 25MM

## IRRIGATION SYSTEM DUTY

30 L/MIN @ AN OPERATING PRESSURE OF 300 kPa

NOTE: A FLOW vs PRESSURE TEST MUST BE CONDUCTED PRIOR TO INSTALLATION COMMENCING TO ENSURE ABOVE SYSTEM DUTY IS MET. FAILURE TO DO SO MAY RESULT IN SYSTEM NOT FUNCTIONING AS INTENDED

### IRRIGATION NOTES

THIS DRAWING MUST BE READ IN CONJUNCTION WITH THE OTHER CONTRACT DOCUMENTS & ANY INSTRUCTIONS ISSUED DURING THE COURSE OF THE PROJECT. CONTRACTORS SHOULD VERIFY ALL DIMENSIONS AND LEVELS ON SITE PRIOR TO ANY COMMENCEMENT OF IRRIGATION WORKS. IF ANY DISCREPANCIES ARE FOUND, BRING THESE IMMEDIATELY TO THE ATTENTION OF THE IRRIGATION DESIGNER. PRIOR TO COMMENCEMENT OF IRRIGATION WORKS, A FLOW TEST AND PRESSURE TEST SHOULD BE PERFORMED ON-SITE TO CONFIRM SYSTEM DUTY. IF SYSTEM DUTY IS NOT REACHED, A RE-DESIGN MAY BE REQUIRED. IT IS THE RESPONSIBILITY OF THE CONTRACTOR TO VERIFY THE LOCATION OF ALL UNDERGROUND SERVICES PRIOR TO COMMENCING ANY EXCAVATION WITH ALL RELEVANT AUTHORITIES. DISTANCES BETWEEN OUTLETS, VALVES, FITTINGS & THE LIKE ARE INDICATIVE ONLY AND MAY BE ALTERED BY THE CONTRACTOR / INSTALLER AT THEIR DISCRETION.

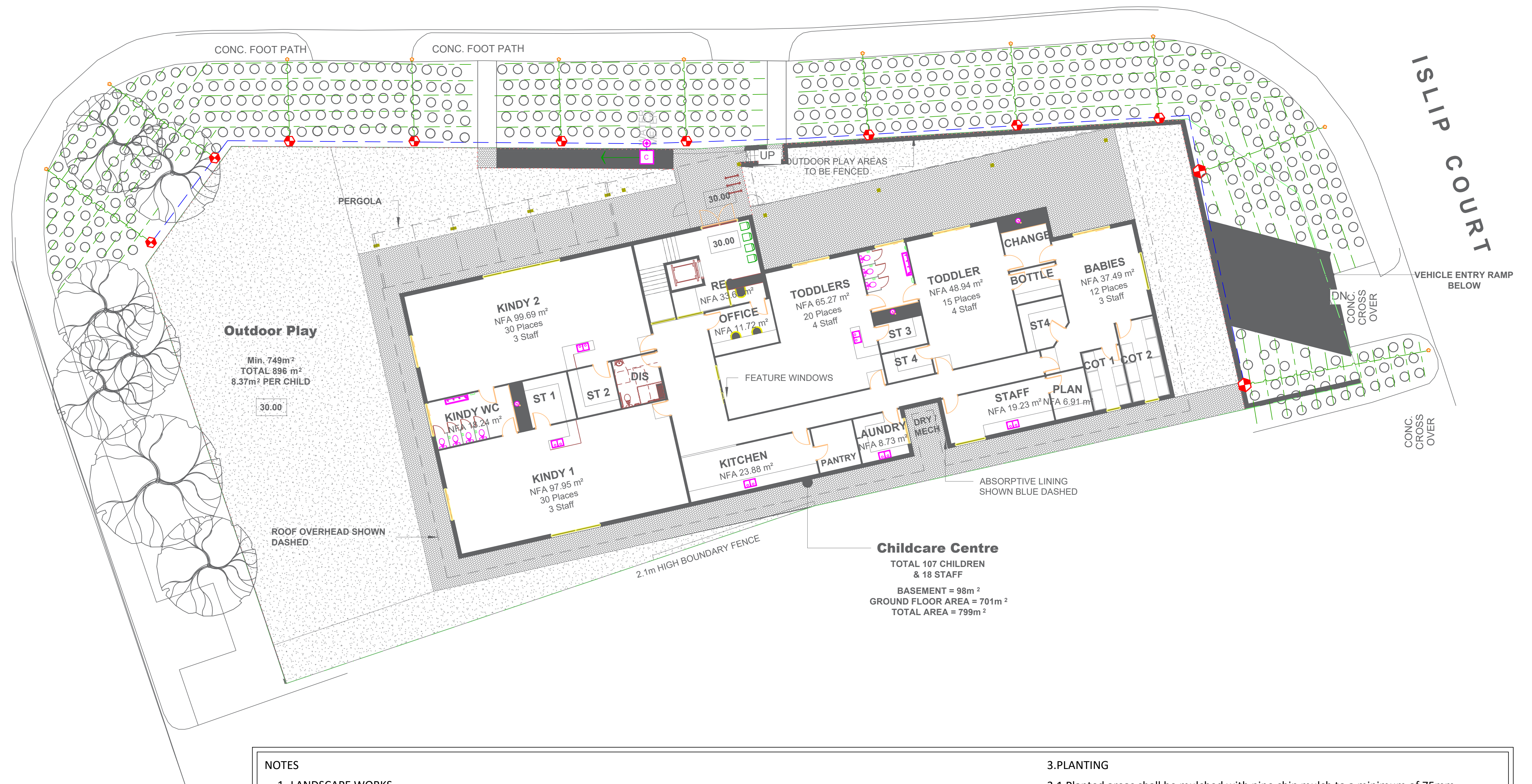

## NOTES

## 1. LANDSCAPE WORKS

- 1.1 All areas are to be fine graded to conform with kerb levels and surrounding surfaces.

- 1.2 Surfaces shall be free from depressions, irregularities, and noticeable changes in grade.

## 2. SOIL PREPARATION

- 2.1 Planted areas shall be spread with min of 50mm soil conditioner ripped into soil to a min depth of 200mm.

- 2.2 Trees in carpark shall have a 2000x2000x600mm deep pit filled with Eclipse structural soil and compacted every 150mm as per specification.

- 2.3 Soil on rooftop garden shall be eclipse light weight soil and garden beds to filled to a minimum of 300mm.

### 3.PLANTING

- 3.1 Planted areas shall be mulched with pine chip mulch to a minimum of 75mm.

- 3.2 Tree locations are as shown please refer to plan.

- 3.3 Shrubs & groundcovers in mixed planting areas are to be planted in random groupings.

- 3.4 All garden beds to be mulched with pine chip at a min of 50mm depth.

[illegible]



PLANT SCHEDULE					
	SPECIES	SPACINGS	SIZE	MATURE SIZE	QTS
SHRUBS					
Acu	ADENANTHOS CUNEATUS	1000 MM	140 MM	2 M	97
Fno	FICINIA NODOSA	1000 MM	140 MM	0.6 M	204
Wlh	WESTRINGIA LOW HORIZONTALIS	1000 MM	140 MM	0.7 M	166
Ssm	SYZYGIUM SMITHII	2000 MM	140 MM	2 M	15



ADENANTHOS CUNEATUS



FICINIA NODOSA



WESTRINGIA ACIFOLIA



SYZYGIUM SMITHII

This drawing is conceptual. Check scale carefully against boundary measurements. Scalebars can be inaccurate. Measurements should be checked on-site prior to quotation and construction. Plans should be printed at actual size on the same sized paper shown in the title block. Fitting to page and adding margins can alter the scale when printed.

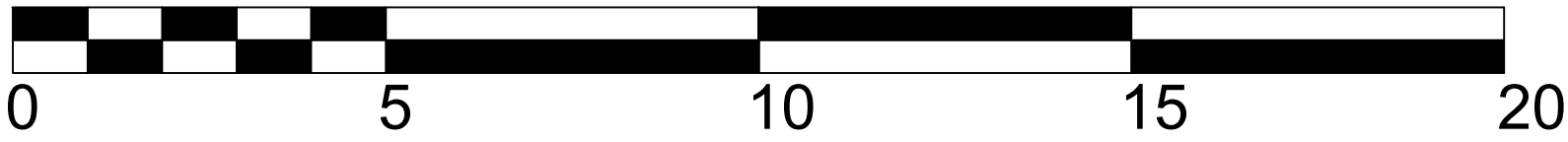

BROADHURST CRES

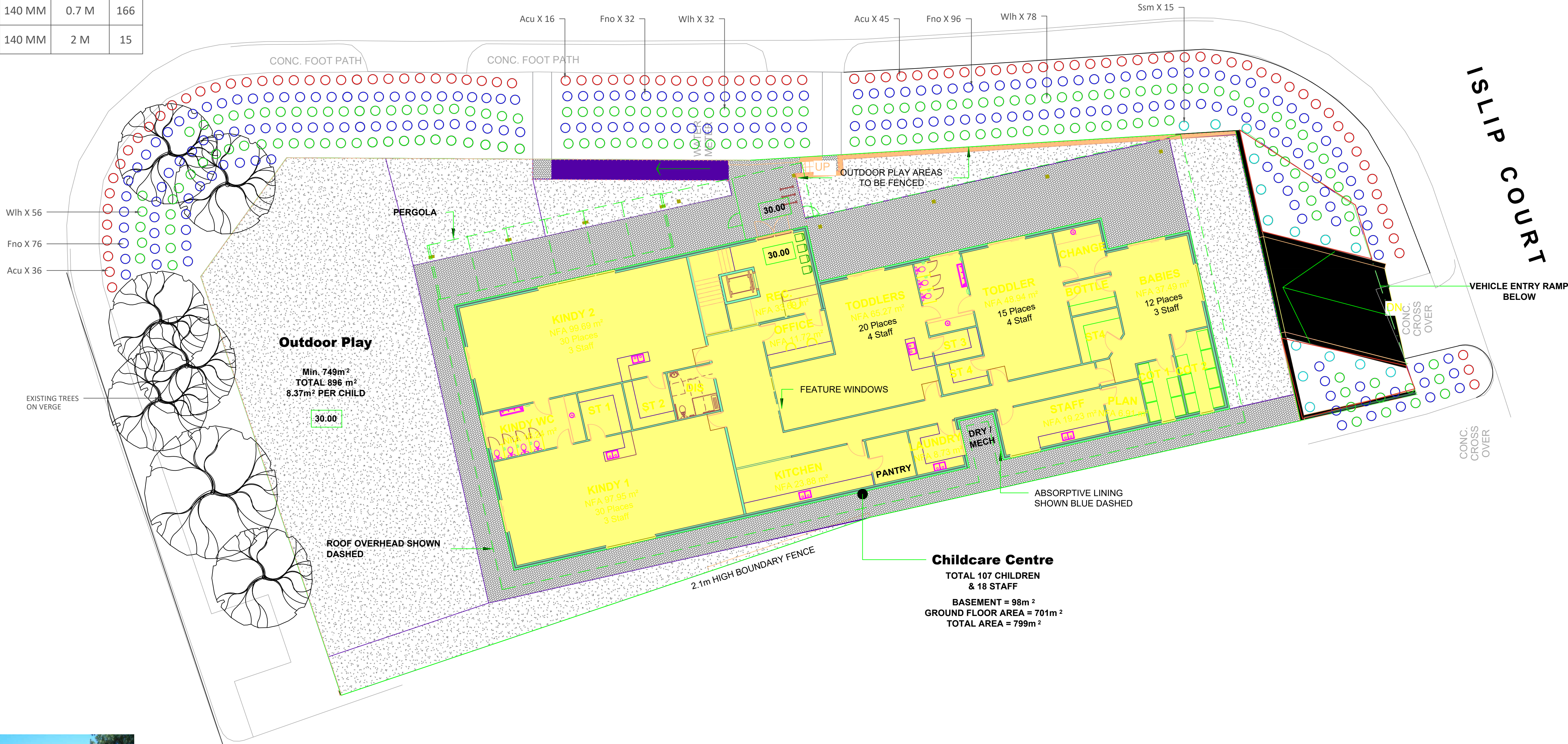

NOTES

1. LANDSCAPE WORKS

1.1 All areas are to be fine graded to conform with kerb levels and surrounding surfaces.
1.2 Surfaces shall be free from depressions, irregularities, and noticeable changes in grade.
2. SOIL PREPARATION

2.1 Planted areas shall be spread with min of 50mm soil conditioner ripped into soil to a min depth of 200mm.
2.2 Trees in carpark shall have a 2000x2000x600mm deep pit filled with Eclipse structural soil and compacted every 150mm as per specification.
2.3 Soil on rooftop garden shall be eclipse light weight soil and garden beds to filled to a minimum of 300mm.

- 3.PLANTING

3.1 Planted areas shall be mulched with pine chip mulch to a minimum of 75mm.
3.2 Tree locations are as shown please refer to plan.
3.3 Shrubs & groundcovers in mixed planting areas are to be planted in random groupings.
3.4 All garden beds to be mulched with pine chip at a min of 50mm depth.



P.O. Box 774  
e-mail: admin@childscapes.com.au  
web: childscapes.com.au

PROJECT  
BATEMAN  
(MEYERSHIRECORE)

DRAWING  
VERGE PLANTING PLAN

ISSUE  
ISSUED FOR FEEDBACK

REVISIONS			
No	DATE	DRAWN	DETAILS
0	11/12/24	NK	PLANTING- ISSUED FOR FEEDBACK
1	13/12/24	NK	PLANTING- ISSUED FOR FEEDBACK

DRAWING NO	SCALE	SHEET	REVISION
L-01	1:150	A1	1

DRAWN	DATE
NK	13/12/24





TREES:



PYRUS CALLERYANA



AGONIS FLEXUOSA

SHRUBS:



ROSEMARY OFFICINALIS



ANIGOZANTHOS MANGLESII



EREMOPHILA GLABRA



ADENANTHOS SERICEUS



HIBISCUS TILIACEUS



P.O. Box 774  
e-mail: admin@childscapes.com.au  
web: childscapes.com.au

PROJECT  
BATEMAN  
(MEYERSHIRECORE)

CLIENT  
-

DRAWING  
PLANTING PLAN

DRAWING NO  
L-02

SCALE  
1:100

SHEET  
A1

REVISION  
0

ISSUE  
ISSUED FOR FEEDBACK

DRAWN  
NK

DATE  
13/12/24

REVISIONS







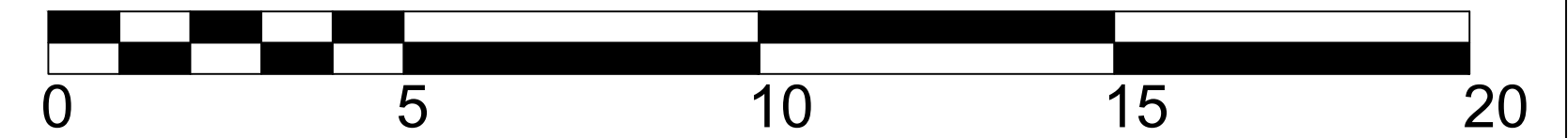



No	DATE	DRAWN	DETAILS
0	13/12/24	NK	PLANTING- ISSUED FOR FEEDBACK



This drawing is conceptual. Check scale carefully against boundary measurements. Scalebars can be inaccurate. Measurements should be checked on-site prior to quotation and construction. Plans should be printed at actual size on the same sized paper shown in the title block. Fitting to page and adding margins can alter the scale when printed.



## IRRIGATION SCHEDULE

SYMBOL	MANUFACTURER/MODEL/DESCRIPTION
	HUNTER PROS SHORT RADIUS NOZZLES SHRUB SPRAY, 300MM POP-UP. CO-MOLDED WIPER SEAL
	HUNTER PROS ADJUSTABLE ARC SHRUB SPRAY, 300MM POP-UP. CO-MOLDED WIPER SEAL WITH UV RESISTANT MATERIAL.
	
SYMBOL	MANUFACTURER/MODEL/DESCRIPTION
	MASTER VALVE RAIN BIRD DVF STANDARD CONFIGURATION. ELECTRIC REMOTE CONTROL VALVE. PLASTIC RESIDENTIAL IN 25MM. WITH FLOW CONTROL.
	RAIN BIRD DVF (GARDENS) 25MM
	HUNTER PRO HC - 24 STATION CONTROLLER PROPOSED LOCATION
	WATER SOURCE ASSUMED LOCATION
	RAIN BIRD QUICK-COUPLING VALVE
	RAIN BIRD TREE DRIP IRRIGATION
	IRRIGATION LATERAL LINE: UPVC CLASS 9 25MM
	IRRIGATION MAINLINE: UPVC CLASS 9 25MM

## IRRIGATION SYSTEM DUTY

30 L/MIN @ AN OPERATING PRESSURE OF 300 kPa

NOTE: A FLOW vs PRESSURE TEST MUST BE CONDUCTED PRIOR TO INSTALLATION COMMENCING TO ENSURE ABOVE SYSTEM DUTY IS MET. FAILURE TO DO SO MAY RESULT IN SYSTEM NOT FUNCTIONING AS INTENDED

## IRRIGATION NOTES

THIS DRAWING MUST BE READ IN CONJUNCTION WITH THE OTHER CONTRACT DOCUMENTS & ANY INSTRUCTIONS ISSUED DURING THE COURSE OF THE PROJECT. CONTRACTORS SHOULD VERIFY ALL DIMENSIONS AND LEVELS ON SITE PRIOR TO ANY COMMENCEMENT OF IRRIGATION WORKS. IF ANY DISCREPANCIES ARE FOUND, BRING THESE IMMEDIATELY TO THE ATTENTION OF THE IRRIGATION DESIGNER. PRIOR TO COMMENCEMENT OF IRRIGATION WORKS, A FLOW TEST AND PRESSURE TEST SHOULD BE PERFORMED ON-SITE TO CONFIRM SYSTEM DUTY. IF SYSTEM DUTY IS NOT REACHED, A RE-DESIGN MAY BE REQUIRED. IT IS THE RESPONSIBILITY OF THE CONTRACTOR TO VERIFY THE LOCATION OF ALL UNDERGROUND SERVICES PRIOR TO COMMENCING ANY EXCAVATION WITH ALL RELEVANT AUTHORITIES. DISTANCES BETWEEN OUTLETS, VALVES, FITTINGS & THE LIKE ARE INDICATIVE ONLY AND MAY BE ALTERED BY THE CONTRACTOR / INSTALLER AT THEIR DISCRETION.

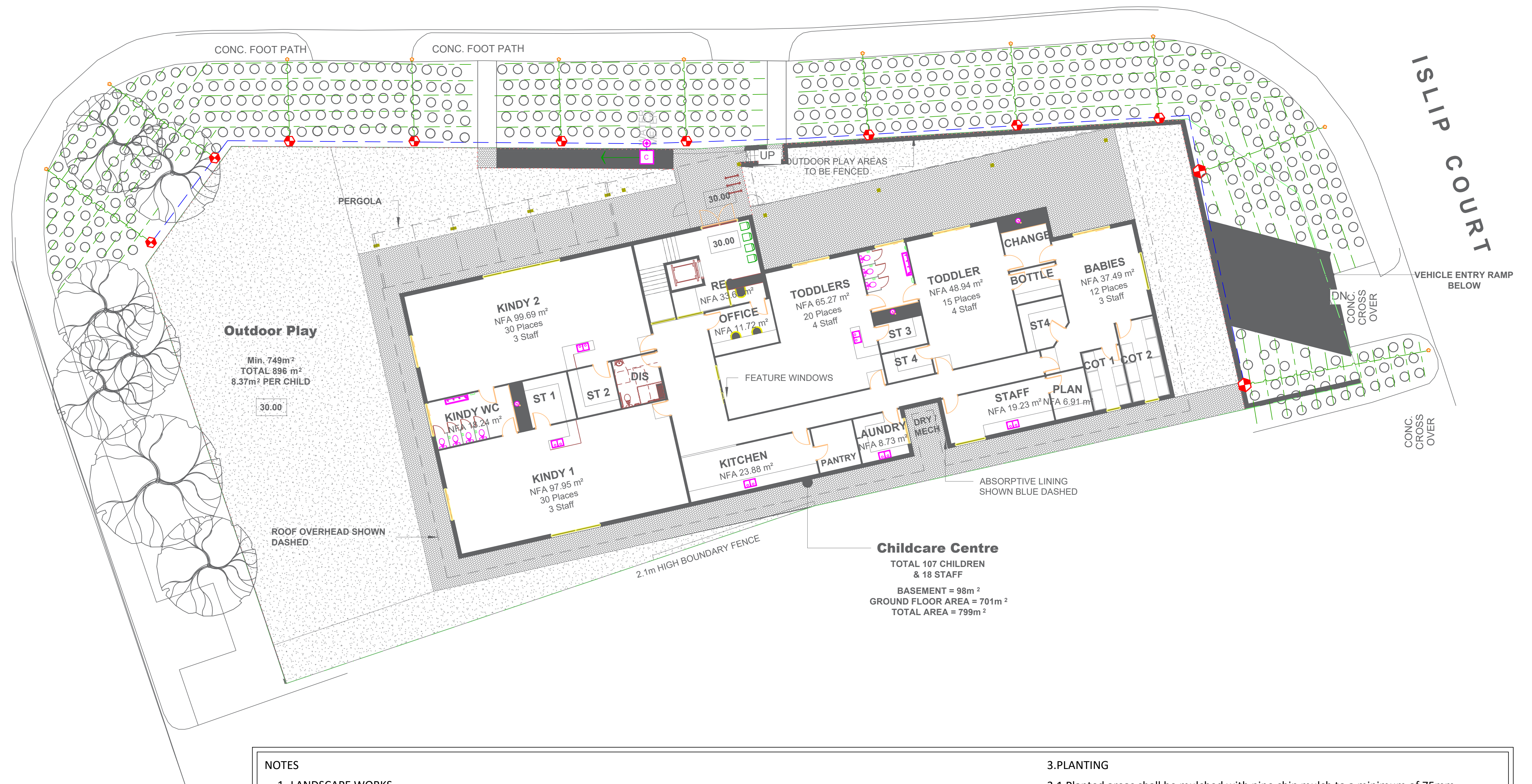

## NOTES

## 1. LANDSCAPE WORKS

- 1.1 All areas are to be fine graded to conform with kerb levels and surrounding surfaces.

- 1.2 Surfaces shall be free from depressions, irregularities, and noticeable changes in grade.

## 2. SOIL PREPARATION

- 2.1 Planted areas shall be spread with min of 50mm soil conditioner ripped into soil to a min depth of 200mm.

- 2.2 Trees in carpark shall have a 2000x2000x600mm deep pit filled with Eclipse structural soil and compacted every 150mm as per specification.

- 2.3 Soil on rooftop garden shall be eclipse light weight soil and garden beds to filled to a minimum of 300mm.

### 3.PLANTING

- 3.1 Planted areas shall be mulched with pine chip mulch to a minimum of 75mm.

- 3.2 Tree locations are as shown please refer to plan.

- 3.3 Shrubs & groundcovers in mixed planting areas are to be planted in random groupings.

- 3.4 All garden beds to be mulched with pine chip at a min of 50mm depth.

P.O. Box 774  
e-mail: [admin@childscapes.com.au](mailto:admin@childscapes.com.au)  
web: [childscapes.com.au](http://childscapes.com.au)

[illegible]



PLANT SCHEDULE					
	SPECIES	SPACINGS	SIZE	MATURE SIZE	QTS
SHRUBS					
Acu	ADENANTHOS CUNEATUS	1000 MM	140 MM	2 M	97
Fno	FICINIA NODOSA	1000 MM	140 MM	0.6 M	204
Wlh	WESTRINGIA LOW HORIZONTALIS	1000 MM	140 MM	0.7 M	166
Ssm	SYZYGIUM SMITHII	2000 MM	140 MM	2 M	15



ADENANTHOS CUNEATUS



FICINIA NODOSA



WESTRINGIA ACIFOLIA



SYZYGIUM SMITHII

This drawing is conceptual. Check scale carefully against boundary measurements. Scalebars can be inaccurate. Measurements should be checked on-site prior to quotation and construction. Plans should be printed at actual size on the same sized paper shown in the title block. Fitting to page and adding margins can alter the scale when printed.

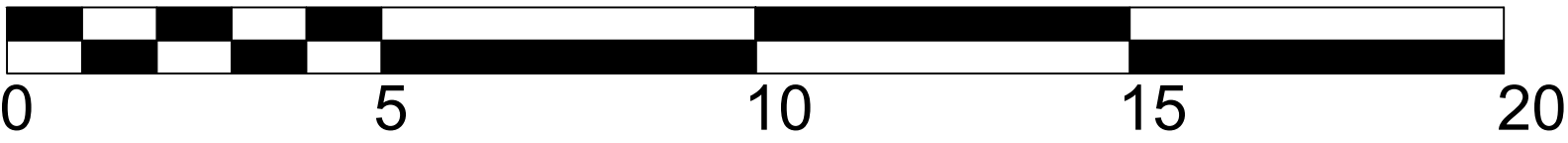

BROADHURST CRES



NOTES

1. LANDSCAPE WORKS

1.1 All areas are to be fine graded to conform with kerb levels and surrounding surfaces.
1.2 Surfaces shall be free from depressions, irregularities, and noticeable changes in grade.
2. SOIL PREPARATION

2.1 Planted areas shall be spread with min of 50mm soil conditioner ripped into soil to a min depth of 200mm.
2.2 Trees in carpark shall have a 2000x2000x600mm deep pit filled with Eclipse structural soil and compacted every 150mm as per specification.
2.3 Soil on rooftop garden shall be eclipse light weight soil and garden beds to filled to a minimum of 300mm.

- 3.PLANTING

3.1 Planted areas shall be mulched with pine chip mulch to a minimum of 75mm.
3.2 Tree locations are as shown please refer to plan.
3.3 Shrubs & groundcovers in mixed planting areas are to be planted in random groupings.
3.4 All garden beds to be mulched with pine chip at a min of 50mm depth.



P.O. Box 774  
e-mail: admin@childscapes.com.au  
web: childscapes.com.au

PROJECT  
BATEMAN  
(MEYERSHIRECORE)

DRAWING  
VERGE PLANTING PLAN

ISSUE  
ISSUED FOR FEEDBACK

REVISIONS			
No	DATE	DRAWN	DETAILS
0	11/12/24	NK	PLANTING- ISSUED FOR FEEDBACK
1	13/12/24	NK	PLANTING- ISSUED FOR FEEDBACK

DRAWING NO	SCALE	SHEET	REVISION	DRAWN	DATE
L-01	1:150	A1	1	NK	13/12/24