

13 June 2025

## **Addendum Waste Management Plan - revised bin numbers for 391 Canning Hwy, Melville (Rev\_2).**

This summary of revised bin number requirements is provided as an addendum to the Encycle Waste Management Plan Rev\_1 dated 31 March 2023. Since issuing the Waste Management Plan, the number of Independent Living Units (ILU's) has increased from 40 to 48 (90 beds to 108 beds) and the Residential Aged Care (RAC) suites increase from 124 to 126 (144 beds to 162 beds).

Please refer to the original Waste Management Plan for the overall waste management strategy. The bin dimensions are provided in Section 5.5 of the Design Brief report.

### **1.0 Project parameters**

The updated bin numbers are based on the updated Schedule of Accommodation provided by Hassell on 10 June 2025:

#### **Residential Aged Care (RAC)**

Total suites	126
Total beds	162

#### **Independent Living Units (ILUs)**

Total units	48
Total beds	108

The floor areas of the remaining facilities (i.e. GP clinic, commercial tenancy, café, day spa, kitchen and serveries, dining, offices, staff room and activity workshop) of the RAC remain as they were in 2023.

### **2.0 Updated bin numbers**

The City of Melville Guidelines in addition to Encycle's experience and knowledge of the use of the development are used to calculate the generation of waste, recycling and organics.

#### **2.1 Number of bins required: RAC main bin store**

The number of bins to be stored in the main bin store are set out in Table 1.

13 June 2025

Table 1: Number of bins to be stored in the RAC main bin store

Waste stream	Bin size (L)	Number of bins	Collection frequency	Colour code*
General waste (excluding food waste)	660	12	3 x weekly	W
Commingled recycling	660	2	3 x weekly	CM
Confidential paper	240	1	As required	P
Cardboard recycling	1100	1	3 x weekly	CB
Used cooking oil	200	1	As required	CO
Soft plastics recycling	660	1	As required	SP
Organic waste (food)	120	13	Twice weekly	FOGO
Bulk general waste	3 m <sup>2</sup>	1	As required	B
Electronic waste (e-waste)	2 m <sup>2</sup>	1	As required	E
ILU bins to be stored for collection				
General waste	660	2	3 x Weekly	W
Commingled recycling	660	3	3 x Weekly	CM
Food organics and garden organics (FOGO)	120	6	2 x Weekly	FOGO

\*Note: colour codes should be used in the architectural plans to easily identify bin types.

## 2.2 Number of bins to be stored in ILU intermediate bin store

The number of bins to be stored in the ILU intermediate bin store are set out in Table 2.

13 June 2025

**Table 2: Number of bins to be stored in the intermediate residential bin store on basement level**

Waste stream	Bin size (L)	Number of bins	Collection frequency	Colour code*
General waste	1100	1	3 x week	W
Commingled recycling	1100	2	3 x week	CM
Food organics and garden organics (FOGO)	120	6	2 x week	FOGO

\*Note: colour codes should be used in the architectural plans to easily identify bin types.

The ILUs will have access to a temporary bin store on each level. RAC staff will be responsible for swapping full bins with fresh bins on a daily basis. Full bins will be transferred to a temporary bin store on the lower ground level of the ILU building. The waste and recycling bins from each level will be tipped into the larger bins using a bin lifter in the temporary bin store. Staff will then transfer bins to the main bin store for collection utilising a tug and trailer system (example system provided in Appendix C of the original Design Brief Report).

The number of bins to be stored in the ILUs temporary bin stores on each level are set out in Table 3.

**Table 3: Number of bins to be stored in the temporary residential bin stores on each level**

Waste stream	Bin size (L)	Number of bins	Collection frequency	Colour code*
General waste	120	1	Every 1 – 2 days	W
Commingled recycling	120	1	Daily	CM
Food organics and garden organics (FOGO)	40	1	Daily	FOGO

\*Note: colour codes should be used in the architectural plans to easily identify bin types.

## 2.3 Bin store location/layout

The main bin store where all bins will be stored for collection is located on the basement level.

13 June 2025

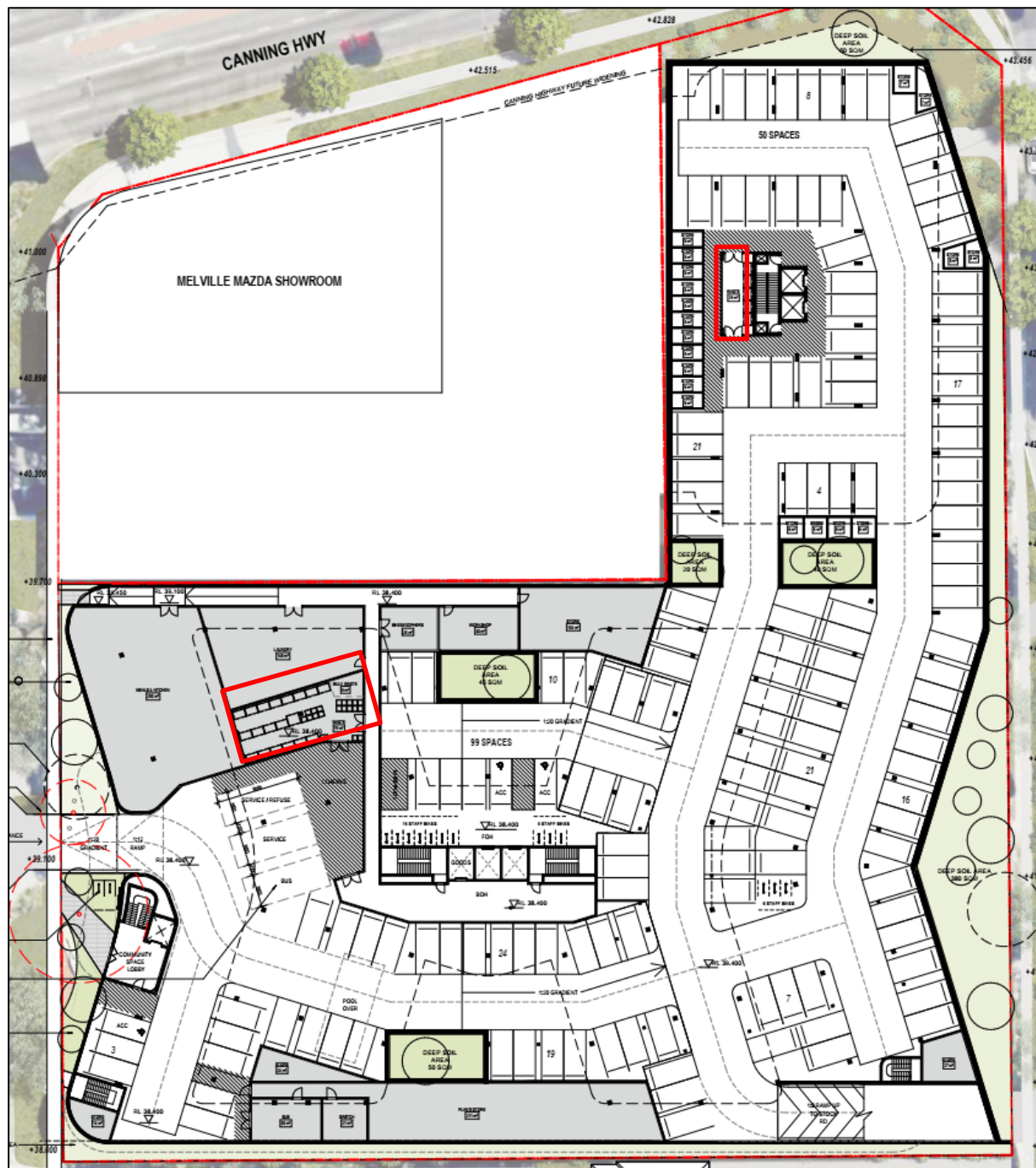

Figure 1: Bin store location

13 June 2025

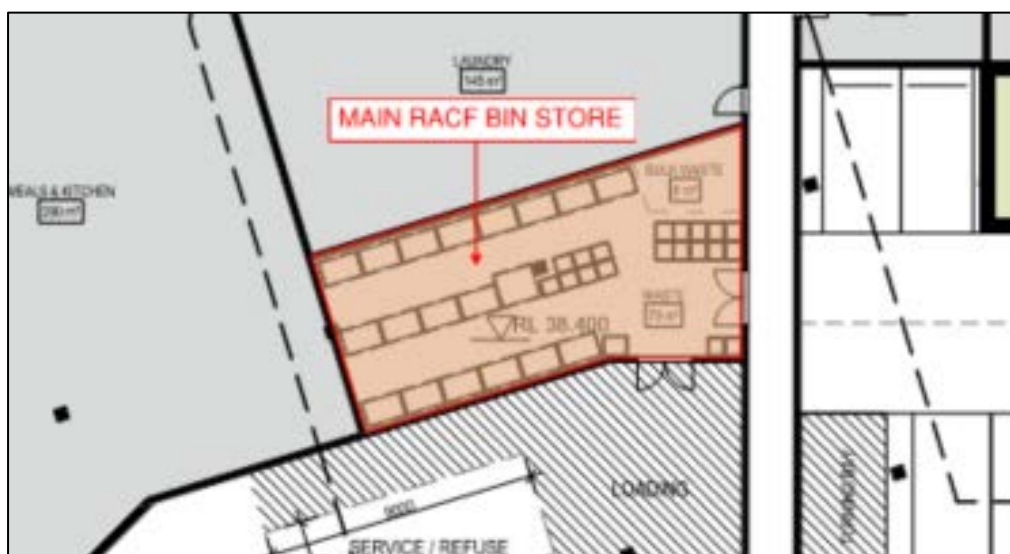

Figure 2: Bin store layout

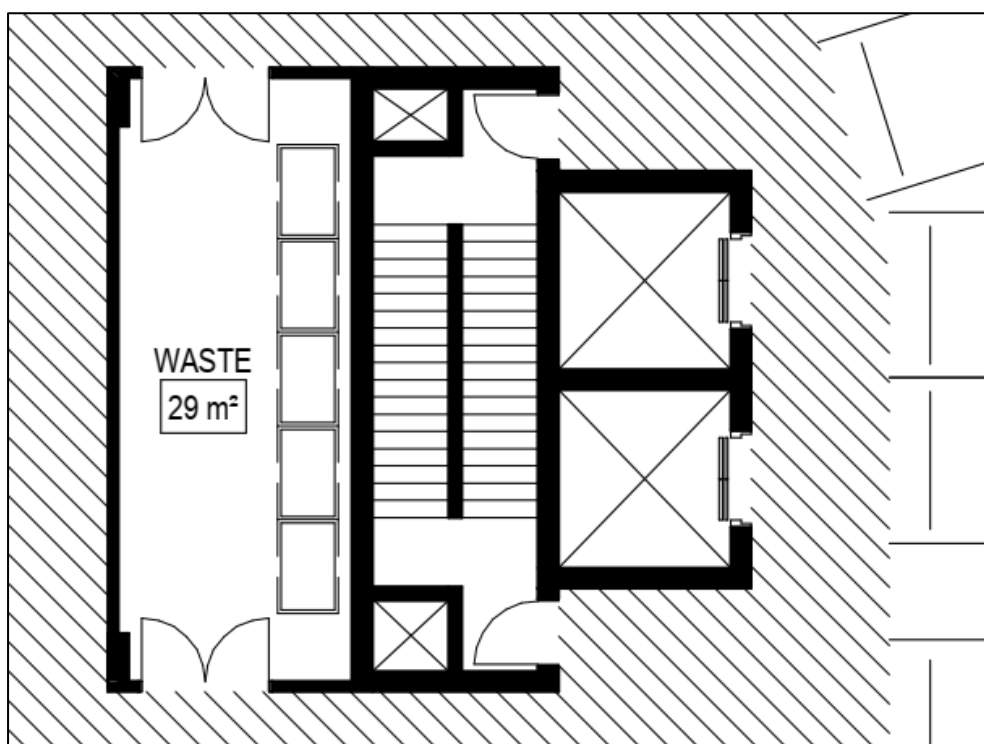

Figure 3: ILU bin store layout